

SERIES 4051-FS2 FACTORY SET 2 - 1/2" PRESSURE REDUCING HOSE VALVES

SPECIFICATIONS

MODELS 4051-FS2

Cast brass valve with rising stem. Internal parts of brass and stainless steel. Red handwheel. Female N.P.T. Inlet and outlet. Integral Supervisory Switch. Listed by Underwriters Laboratories as a checking device in accordance with NFPA 13. Four drilled and tapped ports.

MODEL SELECTION

☐ 4051-FS2 2-1/2

PRESSURE RANGE SUFFIX SELECTION

For factory tagging of valve location, specify location by pressure range suffix. (see manufacturers pressure regulating valve chart)

☐ -CDN ☐ -CN ☐ -DEN ☐ -DN ☐ -EN ☐ -EFN ☐ -FN

NOTE: The in-line installation of a "REG-U-MATIC" sets up a closed system. A relief valve should be installed to eliminate excessive pressure build up due to line surges.



**RATED
400 PSI**



MODEL 4051-FS2 (Shown)

PRODUCT OPTIONS

FINISHES:

☐ -C Rough Chrome Plated

OPTIONS:

☐ -GV Grooved Connection

MODEL DIMENSIONS

Model No.	A Open		A Close		B		C		D		E Radius of Swing		Weight	
	in.	mm	in.	mm	in.	mm	in.	mm	in.	mm	in.	mm	lbs	kg
4051-FS2	13-1/4	337	12-3/4	324	5	127	3-1/2	89	3-1/4	83	5-2/5	138	20	9
4051-FS2-GV	13-1/4	337	12-3/4	324	5	127	5	127	5	127	6-5/8	168	20	9

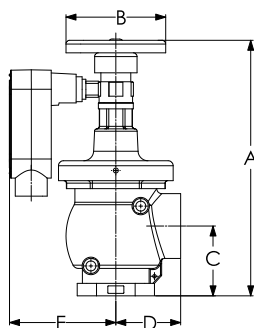

Call Potter Roemer - Fire Pro for current listings and approvals. Dimensions are subject to manufacturer's tolerance and may change without notice. Potter Roemer - Fire Pro assumes no responsibility for use of void or superseded data. © Copyright Potter Roemer - Fire Pro, Member of Morris Group International™ Please visit potterroemer.com for most current specifications.

4051-FA2 SERIES

Date: 1/30/25

MEMBERSHIP



FIRE EQUIPMENT
MANUFACTURERS'
ASSOCIATION



ONFSA
NATIONAL FIRE SPRINKLER ASSOCIATION, INC.



POTTER ROEMER

Headquarters:
P.O. Box 3527
City of Industry, CA
91744 U.S.A.
Los Angeles Area
800-366-3473
626-855-4890

Also in:
New York (800) 526-4592
Chicago (800) 547-3473
Atlanta (800) 762-0542
Miami (833) 744-3473
Dallas (866) 644-3473

www.potterroemer.com

SERIES 4051-FS2 FACTORY SET 2 - 1/2" PRESSURE REDUCING HOSE VALVES

VALVE SELECTION CHART

Valve Type Selection

1. Determine the standpipe residual pressure for each valve location.
2. Select the appropriate valve flow range chart to follow.
3. Locate the valve inlet pressure on the vertical axis of the chart and draw a line from this pressure across the chart.
4. Locate the desired valve outlet residual pressure on the chart horizontal axis and draw a vertical line from this pressure across the chart.
5. From the intersection of the inlet and outlet pressure lines constructed in (3) and (4) above, move horizontally to the nearest valve performance curve (straight lines). This will be the appropriate value for the chosen location.
6. Determine the valve static inlet pressure. This is the sum of the municipal supply static pressure plus the pump churn pressure, less elevation loss.
7. To determine the valve static outlet pressure, refer to the static chart to follow. Locate the valve static inlet pressure on the vertical axis of the chart. Follow across the appropriate valve curve (straight lines) and drop down to the horizontal axis to read valve outlet static pressure.

NOTE: If static pressure is found to exceed the maximum outlet pressure is found to exceed the maximum outlet pressure allowed by NFPA 14, it will be necessary to re-select a valve type to the left of the originally chosen type.

MAXIMUM FLOW RATE LIMITS

Valve Model	Bonnet Type	Max. Flow (gpm)	Max. Pressure (PSI)
4050-FS2 & 4053-FS2	DEN	500	300
4050-FS2 & 4053-FS2	EN	500	260
4050-FS2 & 4053-FS2	EFN	500	240
4050-FS2 & 4053-FS2	FN	500	220
4050-FS2 & 4053-FS2	DN	500	360
4050-FS2 & 4053-FS2	CDN	500	395
4050-FS2 & 4053-FS2	CN	500	400

Call Potter Roemer - Fire Pro for current listings and approvals. Dimensions are subject to manufacturer's tolerance and may change without notice. Potter Roemer - Fire Pro assumes no responsibility for use of void or superseded data. © Copyright Potter Roemer - Fire Pro, Member of Morris Group International™ Please visit potterroemer.com for most current specifications.

4051-FA2 SERIES

MEMBERSHIP



FIRE EQUIPMENT
MANUFACTURERS'
ASSOCIATION



CASPE
American Society of
Plumbing Engineers

ONFSA
NATIONAL FIRE SPRINKLER ASSOCIATION, INC.



POTTER ROEMER

Headquarters:
P.O. Box 3527
City of Industry, CA
91744 U.S.A.
Los Angeles Area
800-366-3473
626-855-4890

Also in:
New York (800) 526-4592
Chicago (800) 547-3473
Atlanta (800) 762-0542
Miami (833) 744-3473
Dallas (866) 644-3473

www.potterroemer.com



Potter Roemer® | 17451 Hurley Street | City of Industry, CA 91746 USA | www.potterroemer.com | 800.366.3473

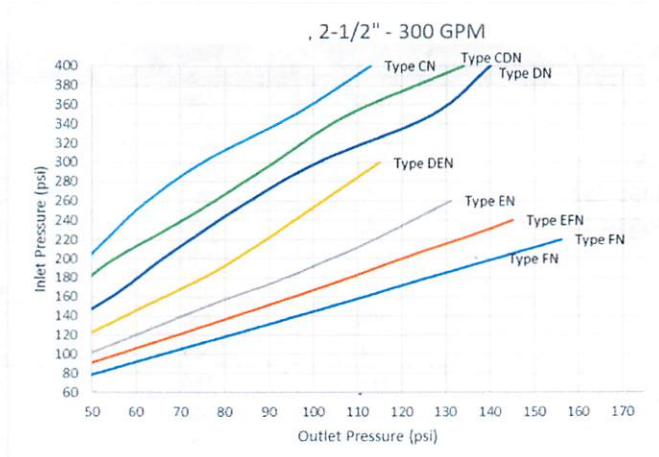
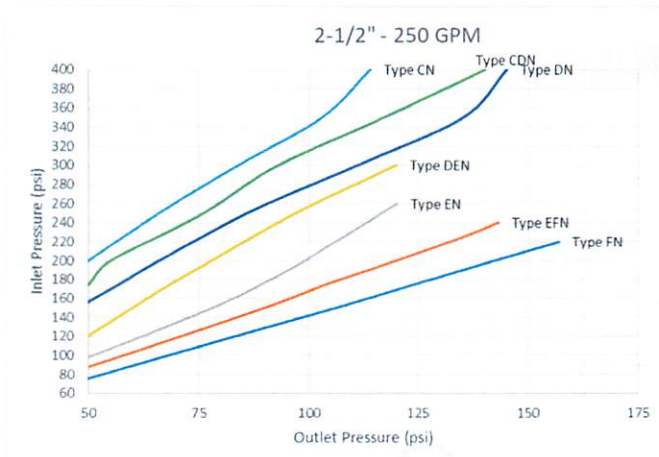
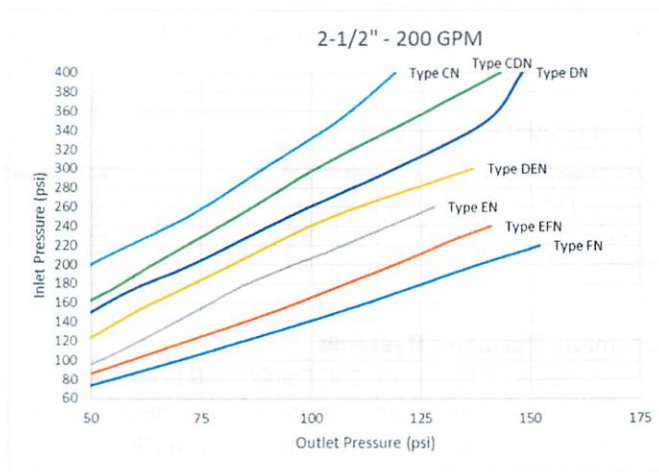
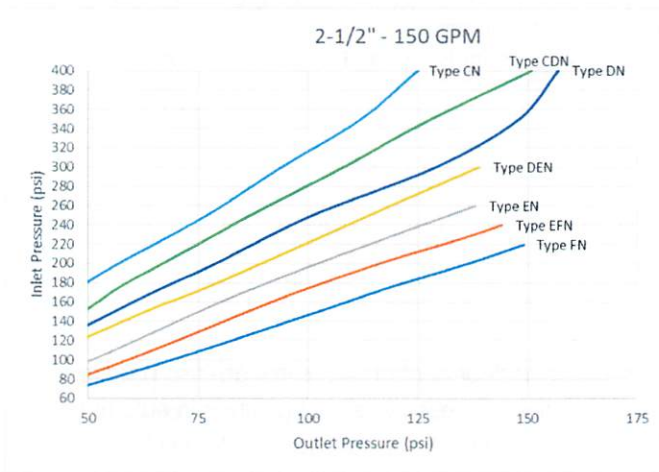
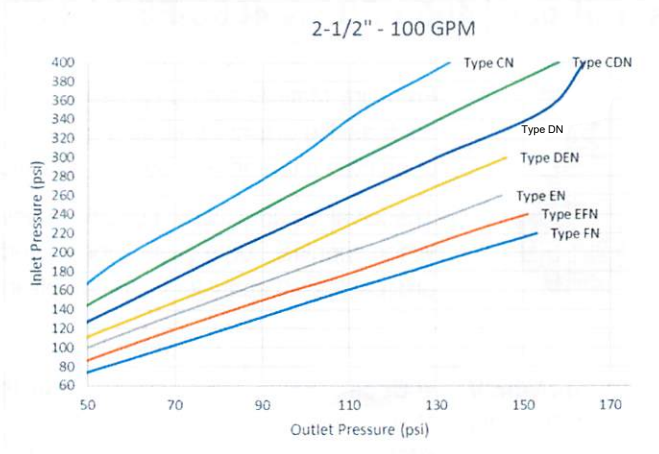
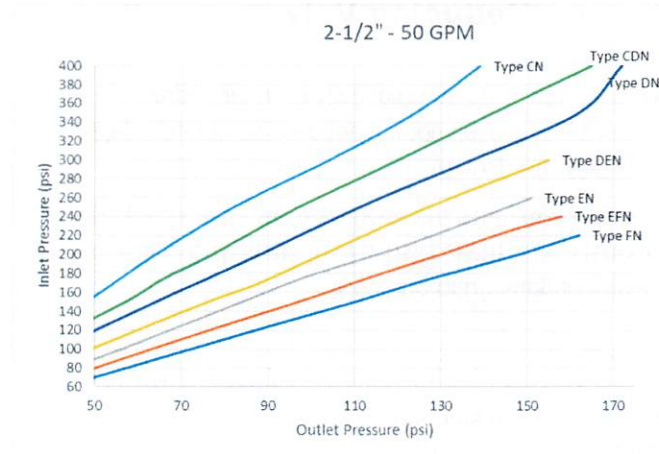



Potter Roemer® | 17451 Hurley Street | City of Industry, CA 91746 USA | www.potterroemer.com | 800.366.3473

