



## Valve Standard

Conforms to AWWA C515 / BS5163

Fusion bonded coating comply with AWWA C550

## Sizes

14", 16", 18" & 24"

## Working Pressure

For 14", 16" & 18" - 250PSI

For 20" & 24" - 200PSI

## Working Temperature

-10°C to 120°C

## Connection Ends

ANSI B 16.42 Class 150

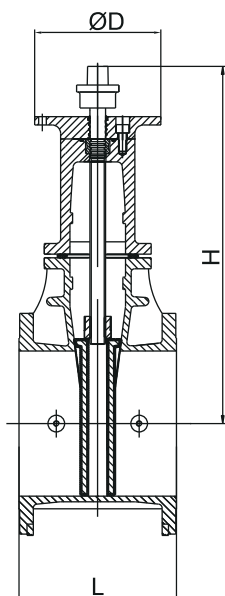

## Materials List

Part Name	Material	Specification
Body	Ductile Iron	A536 65-45-12
Wedge Disc	Ductile Iron EPDM Coated	
Disc Nut	Bronze	ASTM B62
Stem	Stainless Steel	AISI 304/420
Gasket	EPDM	Commercial
Bonnet	Ductile Iron	A536 65-45-12
Thrust Collar	Bronze	ASTM C51100
Gland	Ductile Iron	A536 65-45-12
Wrench Nut	Ductile Iron	A536 65-45-12
Post Plate	Ductile Iron	A536 65-45-12

## Dimensions (mm/inch)

SIZE	mm	350	400	450	500	600
	inch	14	16	18	20	24
L	mm	381	406	432	457	508
	inch	15.00	15.98	17.01	17.99	20.00
H	mm	862	938	1057	1142	1295
	inch	33.94	36.93	41.61	44.96	50.98
D	mm	305	305	305	305	305
	inch	12.01	12.01	12.01	12.01	12.01

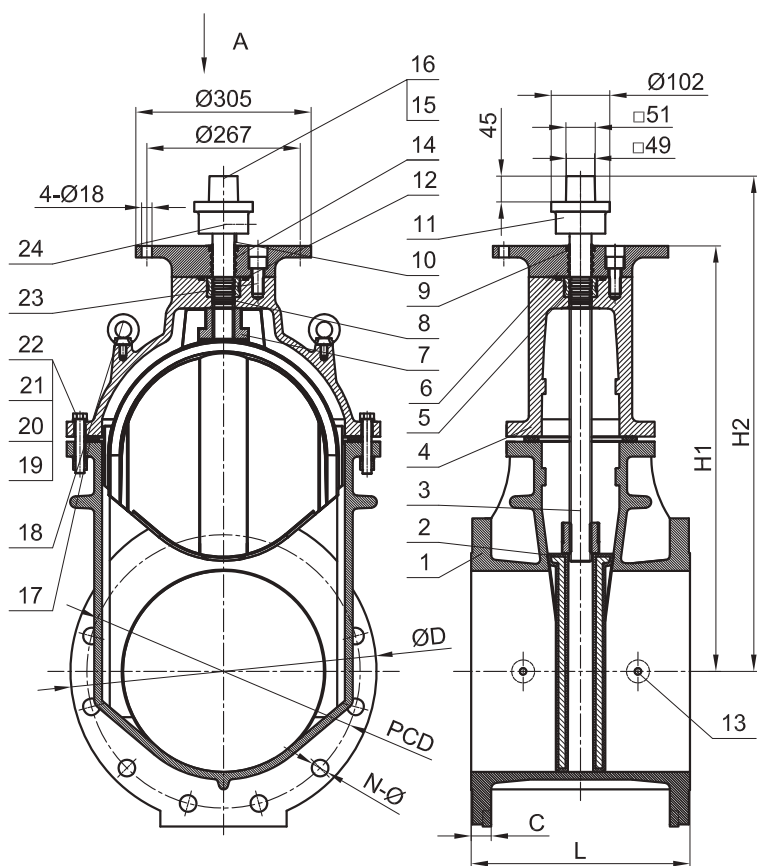

No.	Name	Material
24	Allen long cylindrical side set screws	ASTM SS304
23	Hex cylinder head screw	ASTM SS304 8.8
22	Washer	ASTM SS304
21	Nut	ASTM SS304
20	Spring washer	ASTM SS304
19	Bolt	ASTM SS304 8.8
18	Lifting bolt	Steel
17	Gasket	EPDM
16	Hex cylinder head screw	ASTM SS304 8.8
15	Spring washer	ASTM SS304
14	O-ring	EPDM
13	Square pipe plug	ASTM SS304
12	O-ring	EPDM
11	Square head	ASTM A536 65-45-12
10	Key(A type)	ASTM A1045
9	Dust cover	EPDM
8	O-ring	EPDM
7	Plate nut	ASTM B62 C83600
6	Seal seat	ASTM A536 65-45-12
5	Split ring	ASTM B62 C83600
4	Cover	ASTM A536 65-45-12
3	Shaft	AISI SS304
2	Seat rubber coating	ASTM A536 65-45-12+EPDM
1	Body	ASTM A536 65-45-12

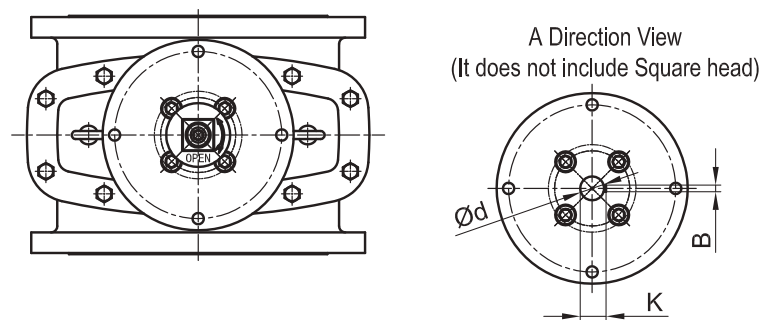

DN	L	H1	H2	ØD	C	ANSI 150		Open the number of turns
						PCD	N-Ø	
350	381	741	862	533	35	Ø476.3	12-Ø28.6	29
400	406	816	938	597	38.5	Ø539.8	16-Ø28.6	33.5
450	432	936	1057	640	42.9	Ø577.9	16-Ø32	37.5
500	457	1021	1142	715	42.9	Ø635	20-Ø32	42
600	508	1173	1295	840	49.6	Ø749.3	20-Ø35	50

DN	B	K	Ød
350	10	41	38
400	10	41	38
450	14	48.5	45
500	14	48.5	45
600	14	51.5	48

## Pressure Temperature Chart

